



ADVANCED PRINT MANAGEMENT SOLUTIONS FOR LEGAL PROFESSIONALS

The evolving landscape of client billing now includes savvy corporate clients pressuring their outside counsel for projected costs and billing transparency. Can your firm bid on prospective client matters with confidence that the projected costs are within a realistic margin? Canon Solutions America can help firms surface key metrics with solutions capable of collecting, reporting, and analyzing workflow costs.

Whether you run a small practice or work in a large firm or legal department, managing print costs in document-intensive legal environments is a challenge. Canon imageRUNNER ADVANCE systems can help your firm save money, increase productivity, and influence user behavior. Canon Solutions America's print management software and services help enable your legal staff to work more efficiently, reduce costs, and ensure clients are billed accurately for document and device-related expenses such as meter reads, supply purchases, and service calls.

Increasing Efficiency with Insight

uniFLOW METRICS ANALYSIS

Poor use of assets can impact productivity and limit a firm's ability to compete effectively. Canon's uniFLOW print-and-scan management solution help manage and monitor copy, print, and scan-related costs. Firms can use uniFLOW to obtain in-depth reports of their document workflow to help identify, remediate, and improve asset use.



ANALYSIS

- Active Metrics
- Reporting
- Performance Analysis

REMEDIATION

- Routing Rules

By implementing print rules, uniFLOW can redirect jobs appropriately so that only small print jobs are routed to laser printers while larger jobs are rerouted to more cost effective and faster multifunctional devices. Very large print tasks can even be rerouted to the central print room.

In addition, users can be forced to print only in black-and-white and duplex. Double-sided printing and deleting print jobs that have not been released helps save paper and money.

uniFLOW can help law firms implement an environmental printing strategy to help save money and improve environmental performance.

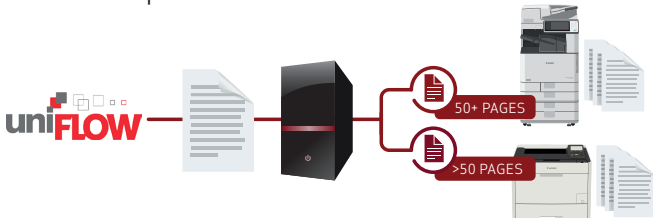

Example of rules-based print routing based on page count per job.

Improve Realization Rates with Better Cost-Recovery Integration

Clients are asking for more transparency and forecasting from their outside counsel. This means law firms need better ways to track expenses while also containing costs to increase



CANON SOLUTIONS AMERICA

Canon, imageRUNNER, and MEAP are registered trademarks of Canon Inc. in the United States and elsewhere. All other referenced product names and marks are trademarks of their respective owners and are hereby acknowledged. Neither Canon Inc. nor Canon U.S.A., Inc. nor Canon Solutions America, Inc. represents or warrants any third-party product or feature referenced hereunder. Specifications and availability subject to change without notice. All screen images are simulated. Not responsible for typographical errors.

© 2020 Canon Solutions America, Inc. All rights reserved.

profitability. With embedded applications that leverage the Canon MEAP platform, you can seamlessly connect your devices with Equitrac, Copittrak, and nQueue Billback applications.



Secure Account Management with myCSA

Canon Solutions America provides complimentary access to the myCSA Secure Account Management Portal, which allows administrators to view fleet status, view or enter meter reads, place service calls, order supplies, as well as manage device subscriptions for automatic meter reading and auto toner replenishment. myCSA also allows authorized users 24/7 access to download and pay invoices, participate in online training, order supplies, and review service history.

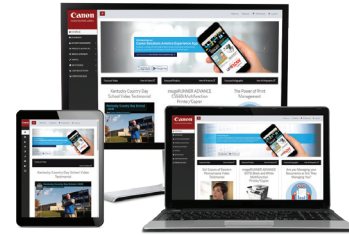

MEAP Applications that Help Lower Print Costs

The PrinterLogic MEAP application on imageRUNNER ADVANCE devices enables law firms to eliminate all print servers and centrally manage their environment from a single, centralized console. PrinterLogic allows users complete management and control over printing environments, from updating print drivers and identifying unmanaged and managed printers to auditing and reporting. The integration between imageRUNNER ADVANCE devices and PrinterLogic helps reduce print-related costs and free up legal IT resources to tackle more critical issues.

PrinterLogic



Admin Console
Central Repository
for Drivers & Settings

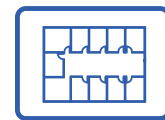

Self-Service Portal
Simplifies Printer Installation
for End-Users



Desktop Client
Manage Drivers & Settings
on the User Desktop

1-800-815-4000 CSA.CANON.COM